

Enclosure Type : PG 360 360 090		Size : 360 X 360 X 90		Weight : 3600 g.	
COVER	EEC03800 / A - Standard Grey		BASE	EEC02000 / A - Standard Grey	
	EEC03800 / B - High visibility yellow				

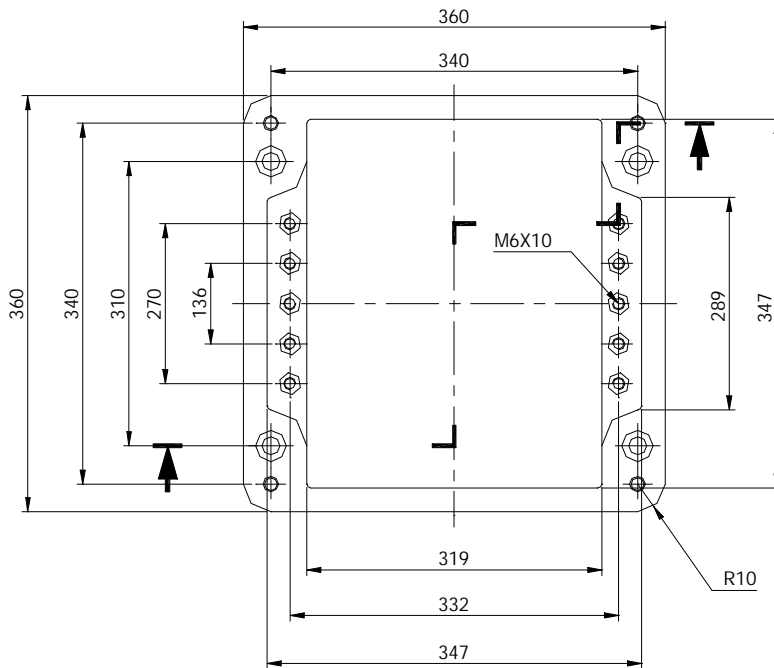
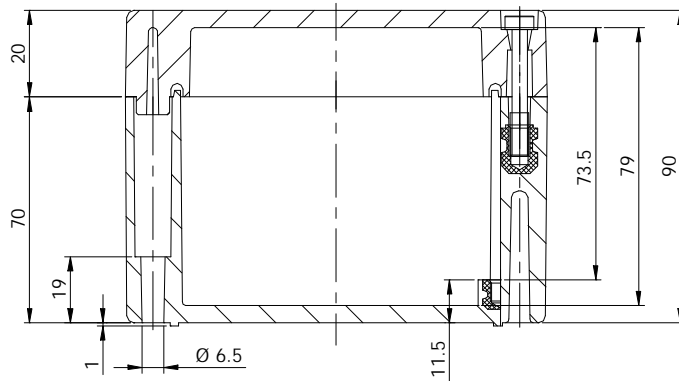

CABLE GLANDS		
Max. No. of cable glands		
	AL	DW
	BL	
PG	AL / BL	CW / DW
7	--	--
9	40	28
11	28	24
13.5	26	20
16	20	18
21	10	8
29	6	6
36	5	4
42	4	3
48	2	2

STD. ASSEMBLY PARTS	
DESCRIPTION	ORDER No.
S.S Cover Screw	EEN02900
Std. C/R Gasket	EEN03405
Alt. Silicon Gasket	EEN04905

ACCESSORIES	
TERMINAL RAIL	
TS 32	EEN00305
TS 35	EEN00205
MOUNTING PLATE - (M.P)	
M.P 1.5mm thick	EEN02100
M.P Screw Kit	EEO03300
M.P Spacer Kit	EEO03400

MOUNTING BRACKET KIT	
Polyamide	EEO00400
Stainless steel	EEO03200

HINGE ASSEMBLY KIT	
Polyamide	EEO00700
Stainless Steel	EEO03500

ASSEMBLY WITH TERMINALS																		
Length of DIN Rail 345mm								Maximum Rail capacity 328mm										
Terminal Blocks	WEIDMULLER											PHOENIX						
	SAK 2.5	SAK 4	SAK 6 N	SAK 16	SAK 35	WDU 2.5	WDU 4	WDU 6	WDU 10	WDU 16	WDU 35	UK 2.5 B	UK 5 N	UK 6 N	UK 10 N	UIK 16	UIK 35	
Technical Information																		
Single Wire cross section (mm ²)	2.5	4	6	16	35	2.5	4	6	10	16	35	4	6	10	16	25	35	
Fine Wire cross section (mm ²)	2.5	4	6	16	35	2.5	4	6	10	16	35	2.5	4	6	10	16	35	
Nominal Volts (V)	550	418	418	726	726	660	660	660	660	660	660	690	800	800	800	400	800	
Load (Amps.)	15	21	26	47	75	26	35	46	63	85	138	32	41	57	76	101	125	
Width of Terminals (mm)	6	6.5	8	12	16	5	6	8	10	12	16	6.2	6.2	8.2	10.2	12.2	15.2	
Max. no of Terminals in Rail - TS 32	52	48	38	26	18	--	--	--	--	--	--	50	50	38	30	26	20	
Max. no of Terminals in Rail - TS 35	--	--	--	--	--	62	52	38	30	26	18							
Max. no of Terminal rails possible	2	2	2	1	1	2	2	2	2	1	1	2	2	2	2	1	1	