

Enclosure Type : PG 250 400 120		Size : 250 X 400 X 120		Weight : 3600 g.	
COVER	EEC03500 / A - Standard Grey		BASE	EEC01800 / A - Standard Grey	
	EEC03500 / B - High visibility yellow				

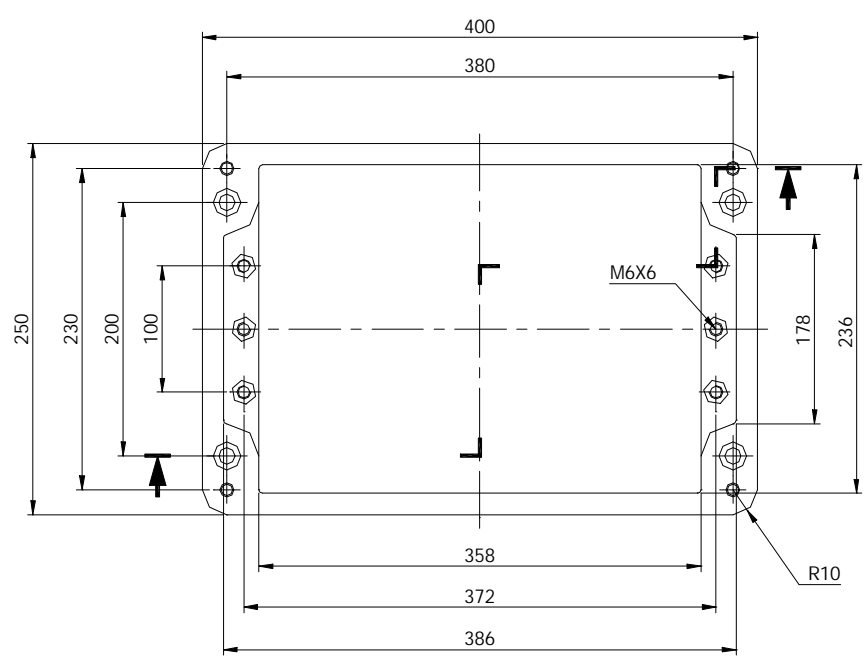
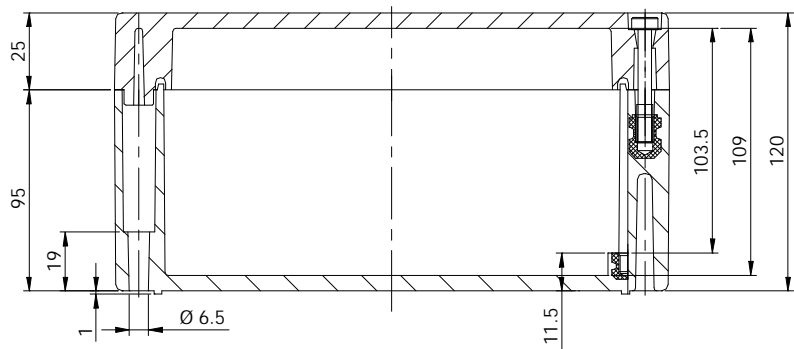

CABLE GLANDS		
Max. No. of cable glands		
PG	AL / BL	CW / DW
7	--	--
9	50	25
11	38	21
13.5	36	18
16	30	14
21	17	8
29	8	4
36	6	3
42	3	1
48	2	1

STD. ASSEMBLY PARTS	
DESCRIPTION	ORDER No.
S.S Cover Screw	EEN02800
Std. C/R Gasket	EEN03404
Alt. Silicon Gasket	EEN04904

ACCESSORIES		
TERMINAL RAIL		
TS 32		EEN00308
TS 35		EEN00208

MOUNTING PLATE - (M.P)	
M.P 1.5mm thick	EEN01900
M.P Screw Kit	EEA03300
M.P Spacer Kit	EEA03400

MOUNTING BRACKET KIT	
Polyamide	EEA00400
Stainless steel	EEA03200

HINGE ASSEMBLY KIT	
Polyamide	EEA00700
Stainless Steel	EEA03500

**ASSEMBLY WITH TERMINALS**

Length of DIN Rail 384mm      Maximum Rail capacity 368mm

Terminal Blocks	WEIDMULLER											PHOENIX						
	SAK 2.5	SAK 4	SAK 6 N	SAK 16	SAK 35	WDU 2.5	WDU 4	WDU 6	WDU 10	WDU 16	WDU 35	UK 2.5 B	UK 5 N	UK 6 N	UK 10 N	UK 16	UK 35	
Technical Information																		
Single Wire cross section (mm <sup>2</sup> )	2.5	4	6	16	35	2.5	4	6	10	16	35	4	6	10	16	25	35	
Fine Wire cross section (mm <sup>2</sup> )	2.5	4	6	16	35	2.5	4	6	10	16	35	2.5	4	6	10	16	35	
Nominal Volts ( V )	550	418	418	726	726	660	660	660	660	660	660	690	800	800	800	400	800	
Load (Amps.)	15	21	26	47	75	26	35	46	63	85	138	32	41	57	76	101	125	
Width of Terminals (mm)	6	6.5	8	12	16	5	6	8	10	12	16	6.2	6.2	8.2	10.2	12.2	15.2	
Max. no of Terminals in Rail - TS 32	58	54	44	28	22	--	--	--	--	--	--	56	56	42	34	28	22	
Max. no of Terminals in Rail - TS 35	--	--	--	--	--	70	58	44	34	28	22							
Max. no of Terminal rails possible	2	2	2	1	1	2	2	2	2	1	1	2	2	2	2	1	1	